



Sept

Oct

Nov

Dec

Chinese New Year Festival

Feast of Santa Cruz

Mooncake Festival and competition

Deepavali

Feast of St Francis Xavier Christmas

Portuguese Occupation Memorial Day

Declaration of Independance Memorial Day

National Day celebrations

Malacca Carnival & Malaysia Fest

National Day celebrations

Malacca International Tourism Show

Esther Khor Soong Huel

Shopping, Dining, Art & Craft, Flea Market

Bird Watching

Mangrove/Wetland Interpretive Education

Malacca Heritage River Cruise

Traditional martial arts), Traditional Game

Historical Light and Sound Show

## Beyond Retrospective

Mohd Yazid Mohd Yunos

### Jury Review

Mohd Ramzi Mohd Hussain & Lee Wern Ching

### Binding Connectivity

Mohd Yazid Mohd Yunos, Norsidah Ujang & Noorizan Mohamed

### Transformational Camouflage

Mohd Yazid Mohd Yunos, Noorizan Mohamed & Norsidah Ujang

### Stratum Emotions

Noorizan Mohamed, Mohd Yazid Mohd. Yunos & Norsidah Ujang

### Transient Diversion

Norsidah Ujang, Mohd Yazid Mohd Yunos & Noorizan Mohamed

### The Heritage Odyssey

Osman Mohd Tahir, Roziya Ibrahim & Asraf Abdul Rahman



# Beyond Retrospective

Mohd Yazid Mohd Yunos

These 3rd year Bachelor of Landscape Architecture projects located at Bandar Hilir Melaka have exciting potentials as an urban landscape design in an ambitious blend of landscape architecture, urban design and historic preservation. As a renowned urban heritage city, however, designers competed for the privilege of envisioning a quality space that would become central to its bustling tourist urban environment. Moreover, the site accentuates the meandering nature of the Melaka River from one end of the linear site to the other point.

The big challenge is how the designers need to design with respect to the integrity of the historic structure of Bandar Hilir Melaka while communicating with each other regarding the new design elements. In recognizing this, a group of Bachelor Landscape Architecture students proposed several urban landscape design works at Bandar Hilir. It is believed that landscape architects could be key players in reviving the quality and sustainability of Bandar Hilir Melaka from the rapid development which could devalue its heritage value. Furthermore, the previous development had no indication as to how the urban planning and design character of Bandar Hilir Melaka might reflect upon each other. The sense of place was destroyed by the existing development.

Much of the redevelopment in Bandar Hilir by the designers was adjacent to the existing residential development; hence, elevating the importance of urban design considerations. New development ideas by designers should not 'copy' existing urban forms of Bandar Hilir. However, the design characteristics of new development should blend with the aesthetic environment of established neighbourhoods to make both new and old areas more visually appealing.



# Jury Review

Mohd Ramzi Mohd Hussain & Lee Wern Ching

The project shows very good explanation and justification of overall idea and planning process. The design concept shows the maturity and creativity of the student in handling the project. The design idea and interpretation is commendable with continuous flow and good articulation of spaces. The work has displayed a good design process in order to provide a good urban landscape design. A well defined of program strategy, landscape strategy, environment strategy and the sustainable system in the park strategy contributes very much in the overall design. Particularly the understanding and the application of wetland design ideas in urban areas can contribute to the new innovation in urban landscape design. This can contribute as an added-value to the urban landscape and it provide strong ideas to create well urban green network. It also will be a habitat not only for human but flora and fauna. Very good and well organized presentation. The flow is very well defined and presented. The projects are good and challenging urban landscape design project located in a historically and culturally influenced site. It would be advisable also to study the accessibility, permeability, legibility and the robustness of the site in order to get the good planning of this heritage square. However, there are also lacking of integrating the cultural and heritage values of Melaka in the design process, conceptual development and the final stage of presentation. The project shows strong justification of site issues and thinking process. Based on site inventory and analysis, it shows strong understanding of the site and this synthesis is crucial to produce good and high quality of urban landscape design. The project started with good design justification and processes. The overall presentation shows good idea in applying the innovation and creativity in landscape design.

Hasanuddin Lamit & Nik Malik ZainalAbidin

The site has many historical, cultural and archaeological issues which give rise to the site having exciting potentials for any landscape design. The waterfront of Melaka River is going through the process of upgrading and change. To date the result is encouraging with river cruise gaining the popularity among local and foreign tourists. Any work proposed within the area needs to be more intense and purposeful to further enhance the tourist programme. The designer has shown to be sympathetic to the aforementioned issues and this is apparent in her choice of concept and words to describe her appreciation for the site and her design intentions. The meandering nature of the Melaka River adds to the sense of place and the experiential journey from one end of the linear site to another is most appropriate.

However, the proposed development of the large open space across the river from Kampong Morten appears to be bit of overkill especially when the land is regarded to be very expensive. Any proposal of such nature can be viewed to be not viable or feasible. There are too many things to be embedded in such a small area and creation of another water body within it can be deemed as redundant when the Melaka River itself is where the focus should be. There is also no indication as to how the planning and character of the design reflect any part of another immediate area such as Kampong Morten. How it can be sustained is still not clear. Perhaps a proper landscape proposal is more apt for the area which can give opportunities for inhabitants of the village to participate in running the place. The river, without doubt, is a landmark and a very iconic emblem of Melaka and the design proposal has manifested that appreciation but perhaps the level of exploration and interpretation is still not rigorous enough. The intensity of design of the design should not only from the point of planning but also in terms of how the 'journey' can be experienced by the users and visitors.



# Binding Connectivity

Mohd Yazid Mohd Yunos, Norsidah Ujang & Noorizan Mohamed

The work explores the potential of creating a spatial connectivity on unusable and unidentifiable spaces surrounding Bandar Hilir, Melaka. This project instils the essence of cultural landscape to enhance the robustness of the lost urban spaces underneath the concrete flyover. Structurally, red arches visible as architectural place markers are introduced to emphasize the legibility of the flyover. The interactive and reflective pool is incorporated to create the sense of naturalness. The pleasurable design invites people to engage in the attractive spaces below the structure more cohesively.

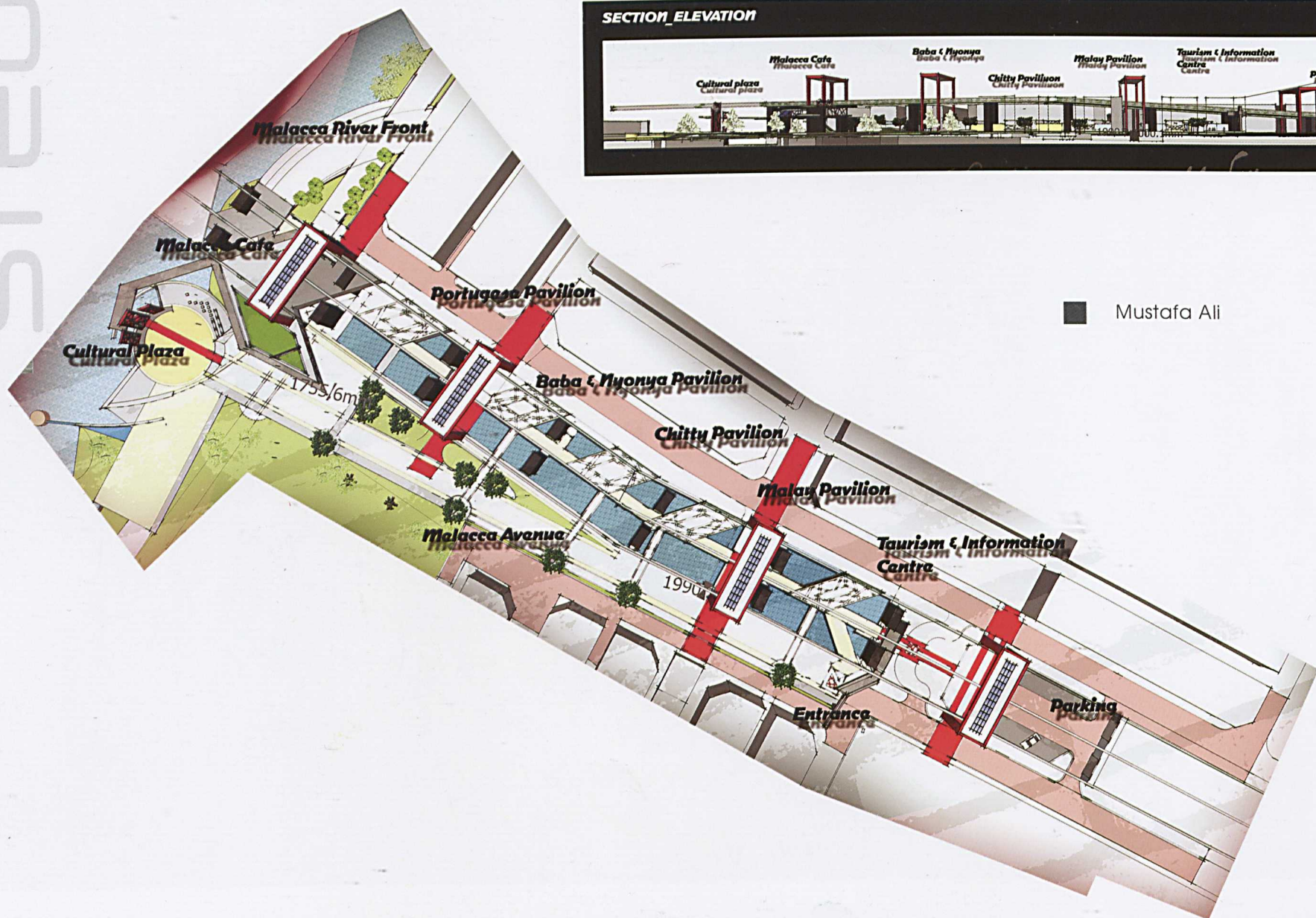

Mustafa Ali



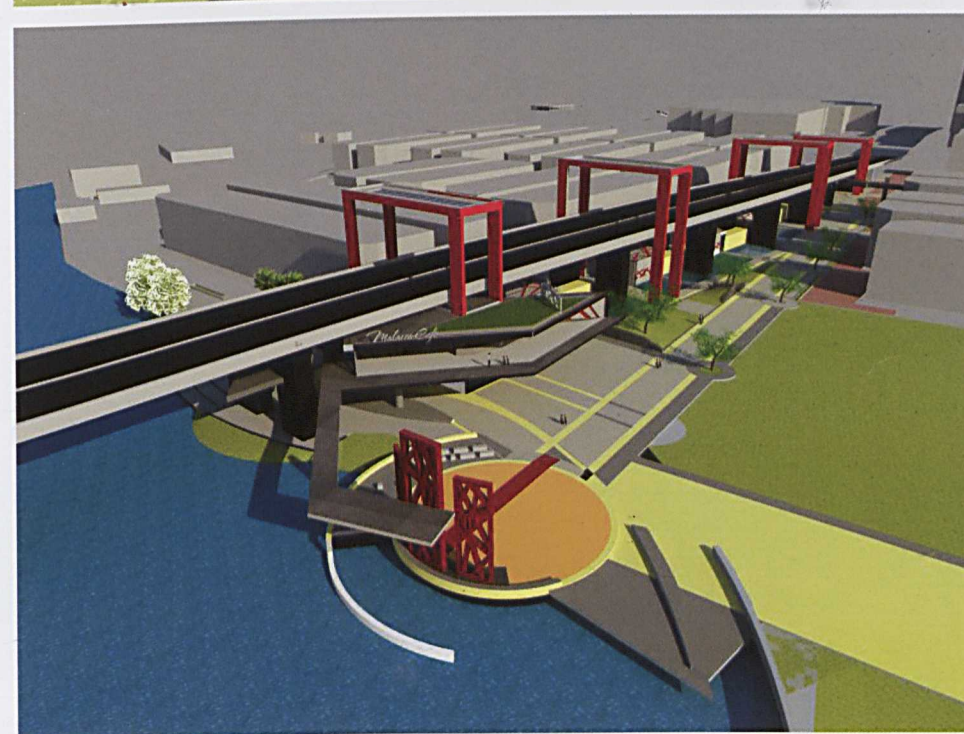



# Transformational Camouflage

Mohd Yazid Mohd Yunos, Noorizan Mohamed & Norsidah Ujang

This work intends to reconstruct the existing detached and mundane spaces in Bandar Hilir Melaka into a functional and identifiable place. The "Camouflage" transforms the core area of Hang Tuah Plaza into a new urban node of the city. The sense of place is strengthened by accentuating the linkages between spaces, the connection between

buildings, and the socio-cultural environment. The new focal spaces provide places for social and commercial activities at various levels while visual connectivity allows the users to appreciate the wider surrounding of the historical city.

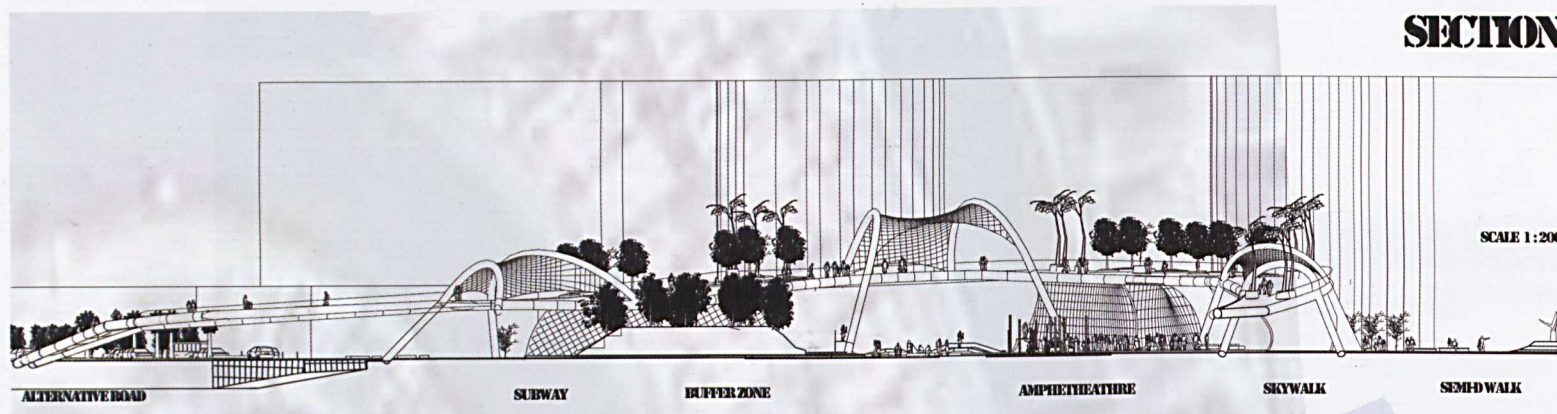







# Stratum Emotions

Noorizan Mohamed , Mohd Yazid Mohd Yunos & Norsidah Ujang

The Heritage Park is a public open space located next to the Malacca River that provides historical experience to users. The park is created to promote coexistence of past, present and future ideas through linkages and connectivity of various urban elements and activities with the surrounding environment. "Stratum Emotions" enhanced the layering concept of historical era influenced by the Portuguese, Dutch, and British until our national independence. The design encouraged people to walk through the epoch of historical period while enjoying the lush greenery and serene environment of the riverside to capture those exciting nostalgic moments of the Historic City of Malacca.





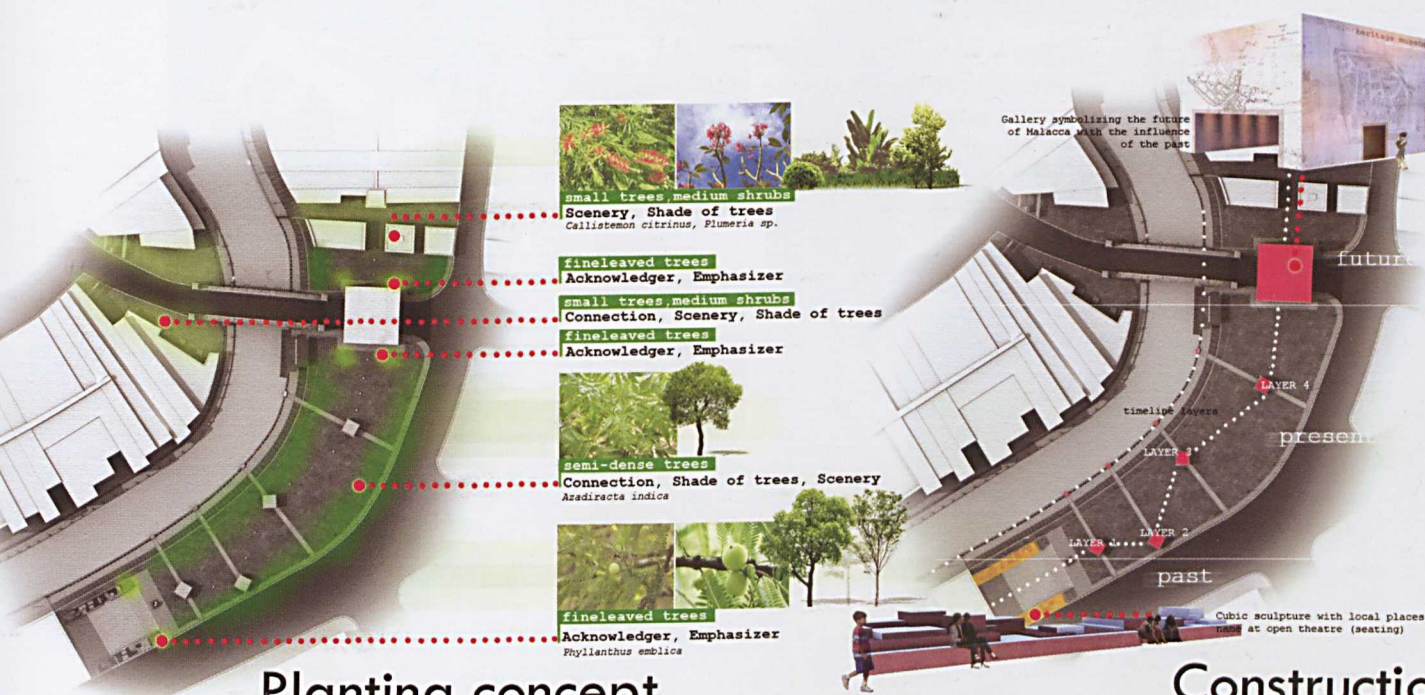

Planting concept

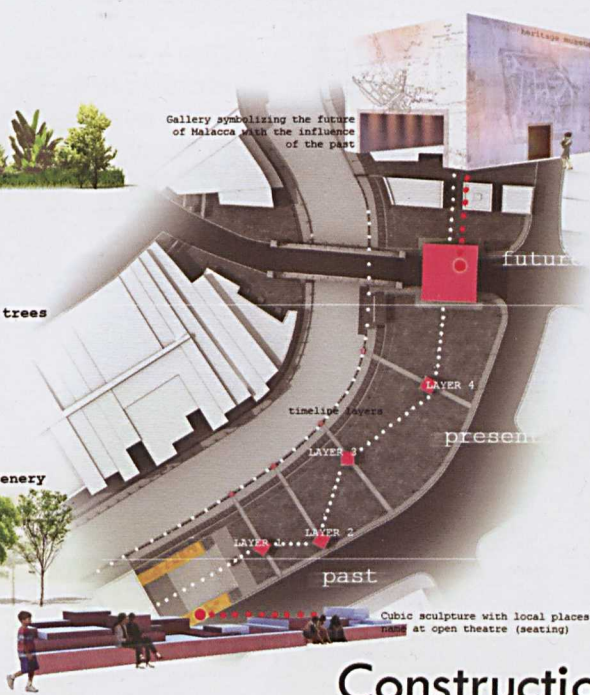

inside relation

Construction concept

outside relation

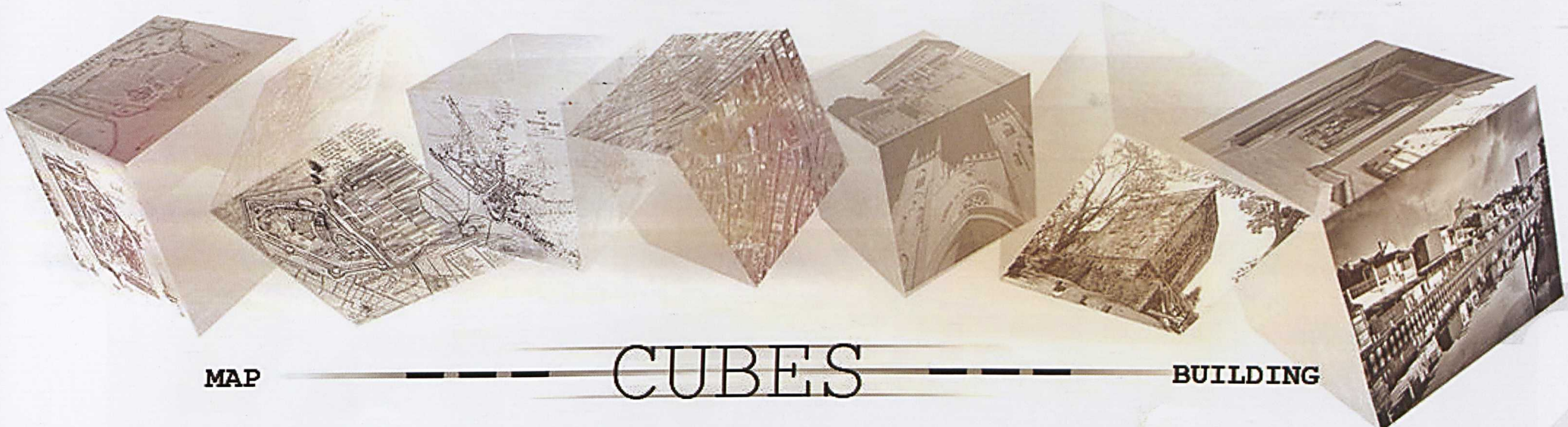
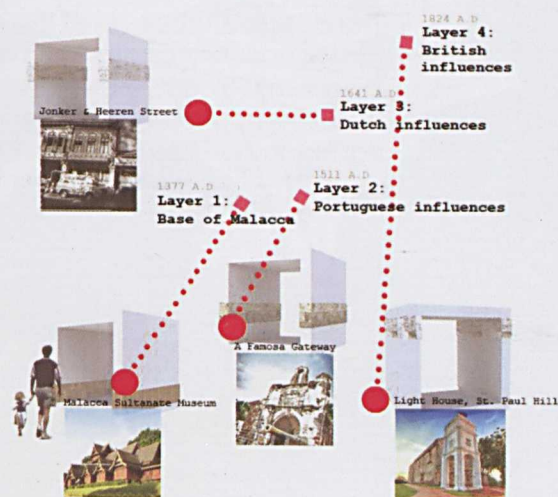



# Transient Diversion

Norsidah Ujang, Mohd Yazid Mohd Yunos & Noorizan Mohamed

The work attempts to capture the spirit and emotion of the Malacca Sultanate against the British invasion. The design encapsulates the memory of the past and metaphorically captured in the presence. "Transient Diversion" is an interpretation of an unrestrained collective emotion defining the moment of historical significance. The distinct form of the open-air gallery

(The Last Beckons) embodies the unity in spirit, represents a catalyst to revive the emotional past evokes the vividness of the hidden political and spiritual power. The gallery is a functional symbol of the people's emotional attachment to history, culture and heritage of Bandar Hilir, Melaka.

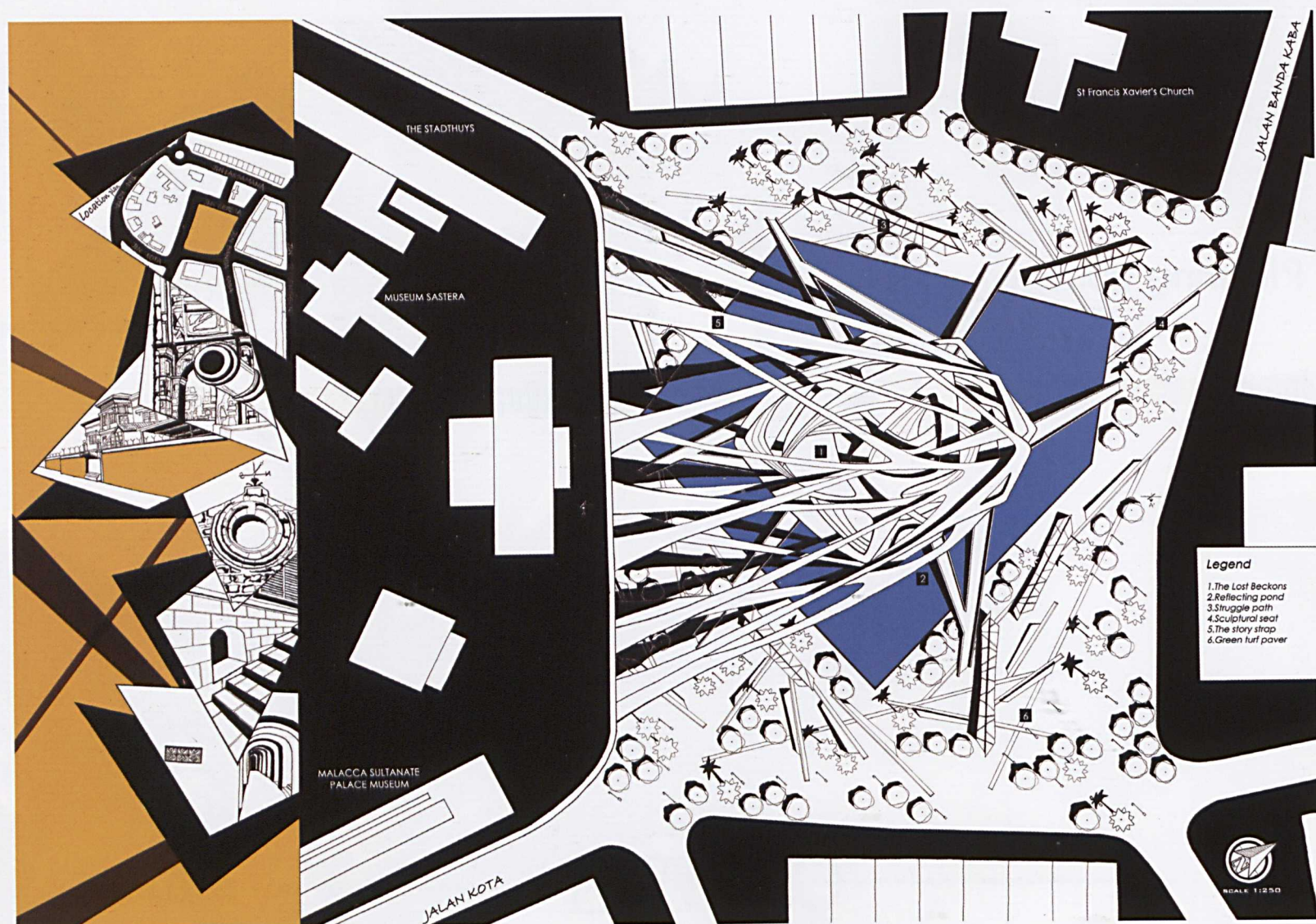

■ Lim Hong Ann



# STAGE 3: THE THINKING PROCESS

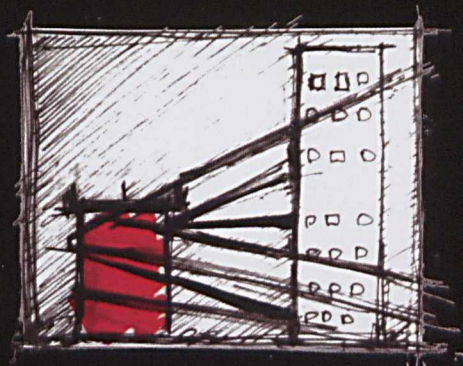
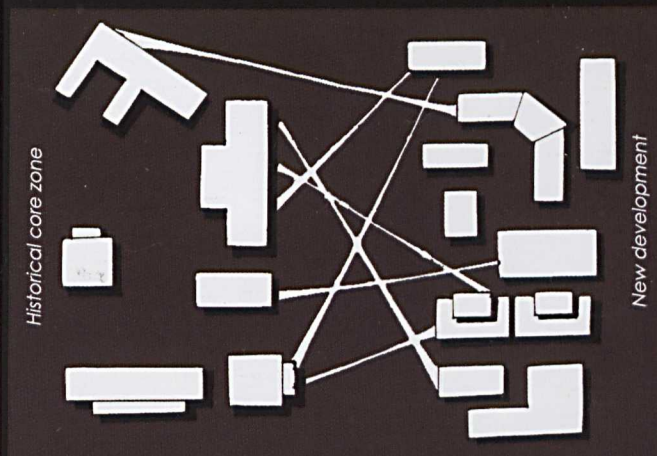

BY CREATING A NEW FORM AS THE CATALYST TO REINTERPRET AND REVIVE THE PAST. BESIDES, THROUGH THE EXTRUDE AND EXAGGERATE FORM MAY STRONGLY EVOKE THE VIVIDNESS OF THE OLD TOWN.

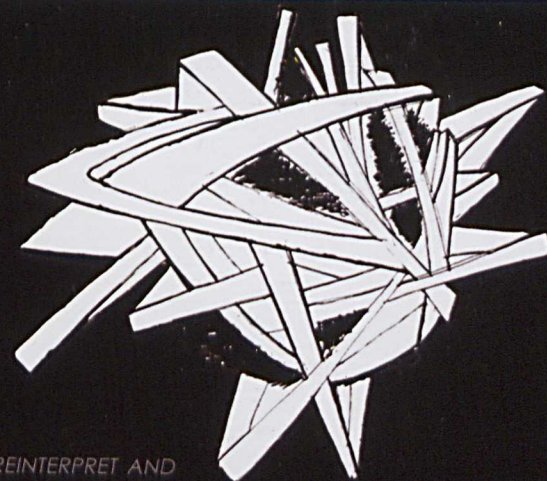

dynamic force

## SITE EXPRESSION

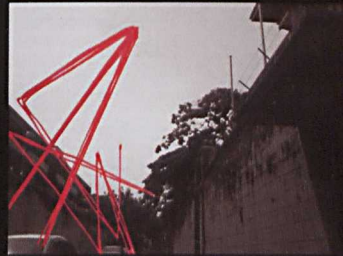
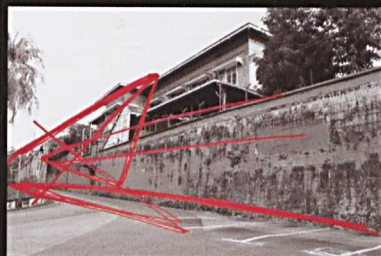

tension.emotional.contrast.juxtaposition

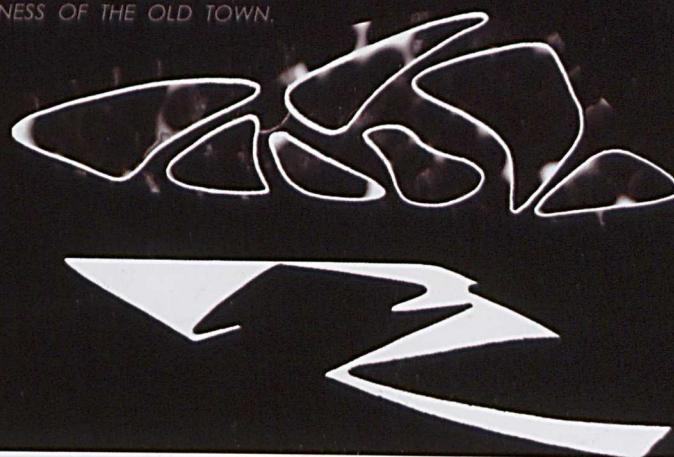

diverse space

fluid dynamism

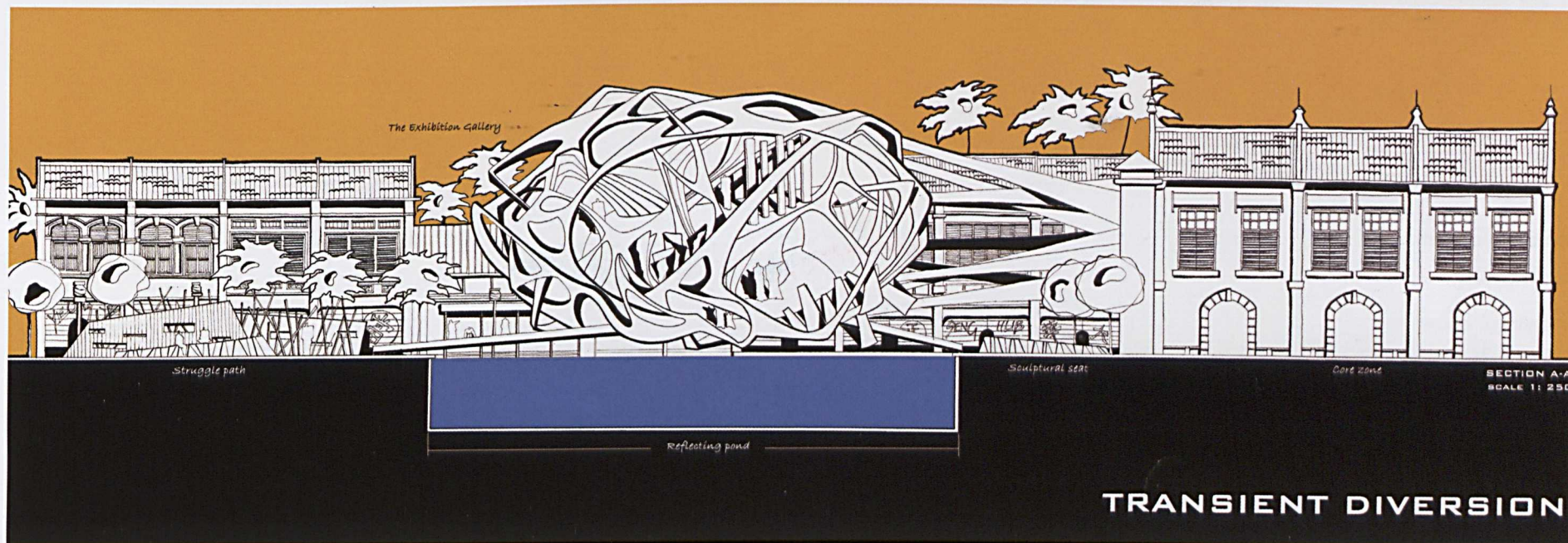



1. Drop-off and entrance
2. Tanjung Pahlawan Management Office (Gift Shop, Chalet counter)
3. Taming Sari Bridge
4. Boat Parking
5. Tuah Floating Restaurant (indoor & outdoor seating)
6. Restaurant service lane
7. Floating Gazebo (dining)
8. Floating Gazebo (resting)
9. Cultural Performance stage / Flea Market
10. Landmark
11. Wetland
12. Floating Gazebo (Jacuzzi)
13. Jebat Multi-purpose Hall
14. Floating Gazebo (Public)
15. Wetland
16. Flying Fox Tower
17. Chalets
18. Residents' Decking
19. Entrance (Kampung Morten link)
20. Firefly rehabilitation
21. Interpretive Mangrove Trail
22. Canopy Walk
23. Public Boardwalk (Starting Point)
24. Tanjung Pahlawan Jetty
25. Bridge to Kampung Morten

Scale 1:300

### Hardscape Concept:

Traditional Malay architecture

### Planting Concept:

Mangrove rehabilitation and wildlife habitat

Mangrove species  
Mangrove-related species

Wetland plants

Malay Village plants





# The Heritage Odyssey

Asraf Abdul Rahman, Roziya Ibrahim & Osman Mohd Tahir

'Heritage Odyssey' emphasizes the unique cultural and priceless historical values along Melaka River. Issues concerning flash flood and low water quality are technically resolved by introducing mechanical storm water management method. The existing architectural and cultural heritage values embedded in the life of Melaka River provide not only the aesthetical visual qualities but also the sensory experiential quality. A journey along the Melaka River will enhance memories and sense of achievements during the glorious past of Melaka.

